



Project
Woollahra Municipal Council

Project
Kiaora Lands Redevelopment
New South Head Rd & Kiaora Lane
Double Bay, NSW

Issue	Description	Date
A	DRAFT DA	17.5.11
B	ISSUED FOR DA	12.10.11
C	ISSUED FOR DA	26.10.11
D	ISSUED FOR DA	10.11.11
E	ISSUED FOR DA	06.02.12

Title	Scale	Date
Site Plan/ Roof Plan	1:500 @ A1, 1:1000 @ A3	February 2012

3109_DA_002-E
25m
50m

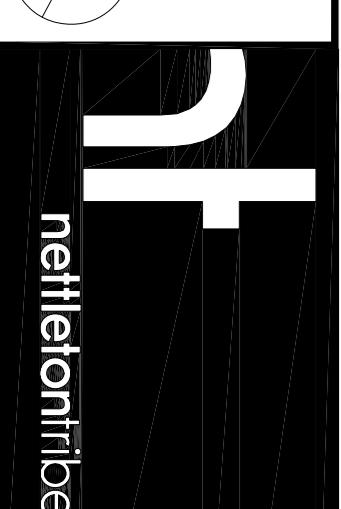
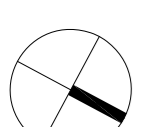

nettleton rife partnership Pty Ltd ABN 58 161 683 122
117 willoughby road crows nest nsw 2065
1 02 9431 6431 f 02 9439 7474
csydney@nettletonrife.com.au w nettletonrife.com.au

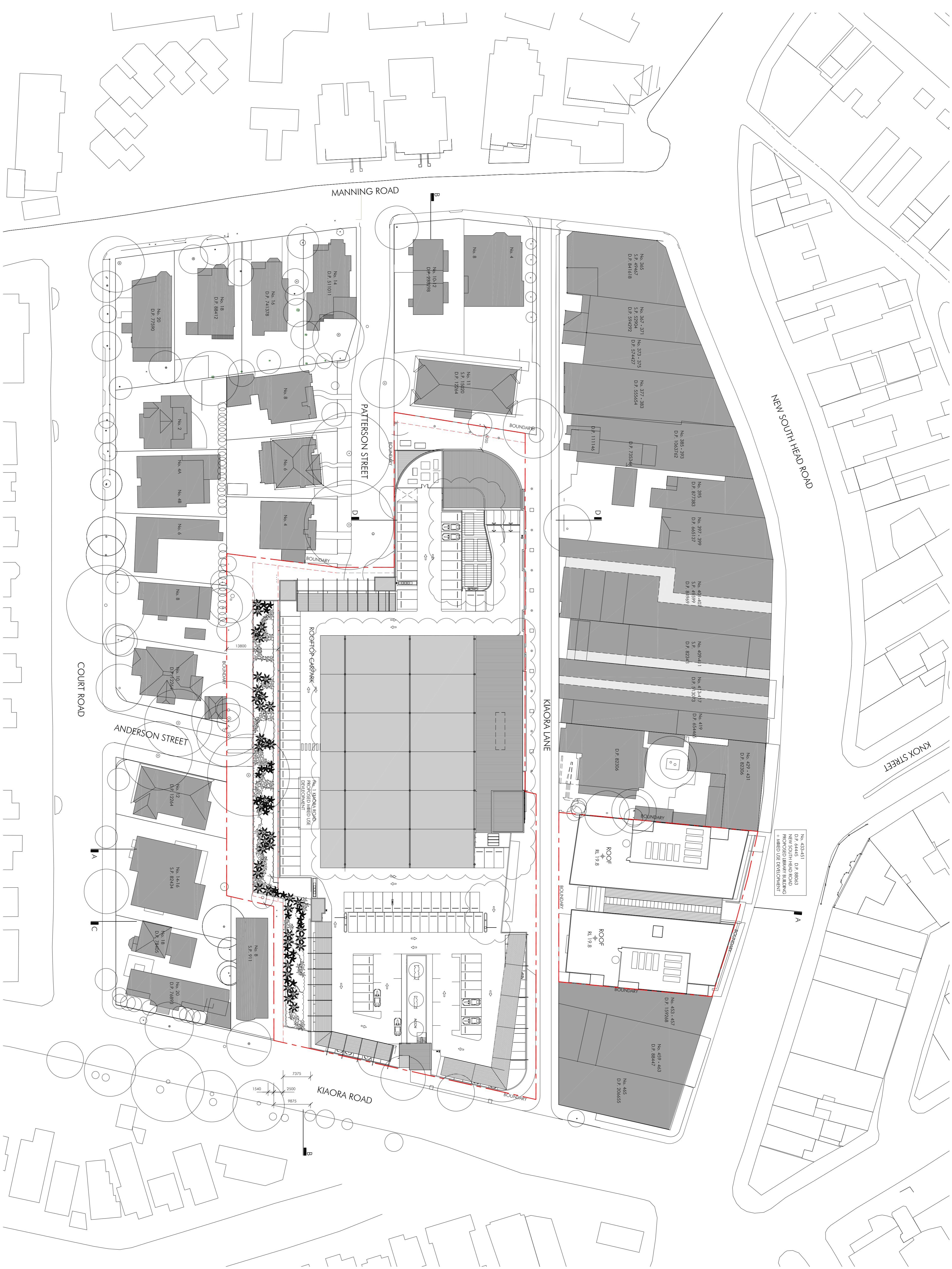

No. 433-434 D.P. 82003
No. 435-436 D.P. 82003
PROPOSED LIBRARY BUILDING
+ WAREHOUSE DEVELOPMENT

7375
2500
9875
1540